

# VAVC-Q2-M22U

## Seal cartridge

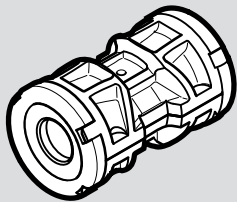

**FESTO**

Festo SE & Co. KG  
Rüter Straße 82  
73734 Esslingen  
Deutschland  
+49 711 347-0

www.festo.com

Assembly instructions

8179545  
2022-08d  
[8179547]



Translation of the original instructions

© 2022 all rights reserved to Festo SE & Co. KG

### 1 Applicable documents

All available documents for the product → [www.festo.com/sp](http://www.festo.com/sp).

Document	Product	Table of contents
Operating instruction	Pinch valve VZQA-C-M22U	-

Tab. 1: Applicable documents

### 2 Safety

#### 2.1 Safety instructions

– Before carrying out any work on the product: switch off the medium supply and secure it against being switched back on.

#### 2.2 Intended use

The seal cartridge controls the media flow.

#### 2.3 Training of qualified personnel

Work on the product may only be carried out by qualified personnel who can evaluate the work and detect dangers. Personnel must have the relevant mechanical training.

### 3 Additional information

– Contact the regional Festo contact if you have technical problems → [www.festo.com](http://www.festo.com).  
– Accessories and spare parts → [www.festo.com/catalogue](http://www.festo.com/catalogue).

### 4 Product Range Overview

#### 4.1 Scope of delivery

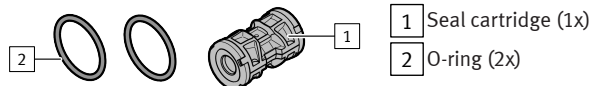

Fig.1

#### 4.2 Not in scope of delivery

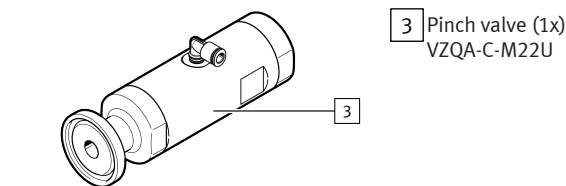

Fig.2

### 5 Assembly

#### 5.1 Preparation

**WARNING**  
Risk of injury from media residues.  
• Wear personal protective equipment during assembly work.

1. Remove the pinch valve [3] from the piping system → 1 Applicable documents.
2. Remove the old seal cartridge in reverse order of assembly.

### 5.2 Assembly

1. Replace the old seal cartridge with an identical seal cartridge [1].  
– Check: identical features of seal cartridge [1] and pinch valve [3].  
Example of identical features for size 6:

Feature	Seal cartridge [1]	Pinch valve [3]
	VAVC-Q2-M22U-6-E	VZQA-C-M22U-6-GG-V4V4E-4
Nominal diameter DN	-6	-6
Shut-off element material	-E	...E

2. Select the grease that is suitable for the installation situation and the media.
3. Select the cleaning agent that is suitable for the installation situation and the media.
4. Clean the pipe [7] with a lint-free cleaning cloth.

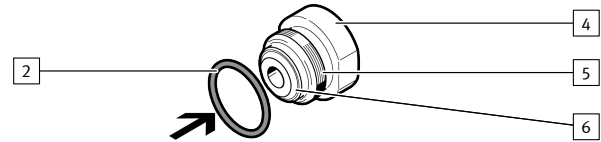

Fig.3

1. Grease the O-rings [2].
2. Grease the threads [5].
3. Grease the contact surfaces [6].
4. Mount the O-rings [2] on both covers [4].

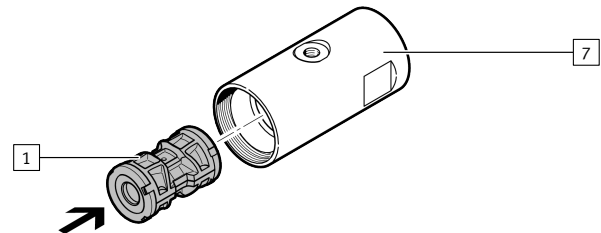

Fig.4

- Push the seal cartridge [1] into the pipe [7].

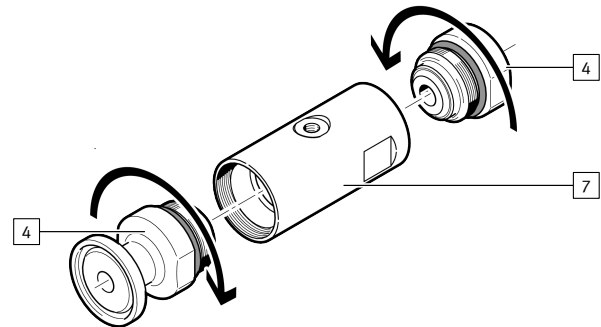

Fig.5

- Tighten the cover [4].

		Cover [4]		
		VZQA-...-...POM	VZQA-...-...V4	VZQA-...-...AL
VAVC-Q2-M22U-6	≈G [Nm]	-	22 25 ± 10 %	22 25 ± 10 %
VAVC-Q2-M22U-15	≈G [Nm]	36 10 ± 10 %	36 60 ± 10 %	36 60 ± 10 %
VAVC-Q2-M22U-25	≈G [Nm]	55 15 ± 10 %	55 60 ± 10 %	55 60 ± 10 %
VAVC-Q2-M22U-50	≈G [Nm]	-	85 60 ± 10 %	85 60 ± 10 %

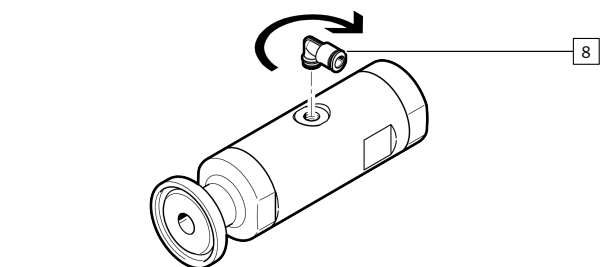

Fig.6

1. Screw in the push-in fitting [8]. Observe the tightening torque → 1 Applicable documents.
2. Check the pinch valve [3] for leaks.
3. Install the pinch valve [3] in the piping system → 1 Applicable documents.